

# Installation instructions

## SOLITEX FRONTA® QUATTRO

### Installation steps



#### 1. Installing the membrane

Roll out the membrane and use galvanised staples that are at least 10 mm (3/8") wide and 8 mm (5/16") long to fasten the membrane in the overlap area in a manner that protects against moisture at intervals of 10-15 cm (4"-6").

Install the membrane to stop approx. 4 cm (2") short of adjacent building components so that a windtight bond can be applied here subsequently.



#### 2. Apply double-sided adhesive tape

Clean the subsurface (dry and free of dust, silicone and grease), stick DUPLEX double-sided adhesive tape to the lower third of the subsequent overlap in a manner that protects against moisture.

Rub tape firmly into place using the pro clima PRESSFIX. Ensure that there is sufficient resistance pressure.



#### 3. Overlapping the membranes

Overlap the membranes by 10-15 cm (4"-6") so that they are watertight. The printed markings are an aid to orientation.



#### 4. Taping over the overlaps

Gradually remove the release film from DUPLEX and stick the overlapping membrane, ensuring that there are no folds or tension.

Rub tape firmly into place using the pro clima PRESSFIX. Ensure that there is sufficient resistance pressure.



**5a. Alternatively: Taping over the overlaps with TESCON INVIS**

Tape TESCON INVIS system adhesive tape centrally to the overlap and stick it down bit by bit so that it is load and wrinkle free.

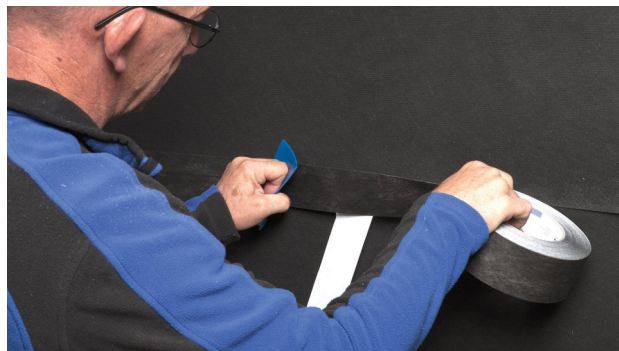

**5b. Alternatively: Taping over the overlaps with TESCON INVIS**

Rub tape firmly into place using the pro clima PRESSFIX. Ensure that there is sufficient resistance pressure.



**6a. Sticking to rough or mineral surfaces (e.g. floorboard)**

Clean the surface.  
Apply a bead of ORCON F system adhesive – at least 5 mm (3/16") thick (more in the case of very rough surfaces).



**6b. Sticking to rough or mineral surfaces (e.g. floorboard)**

Lay the membrane with an expansion joint and not pressing the tape down completely to allow for movement of the parts.

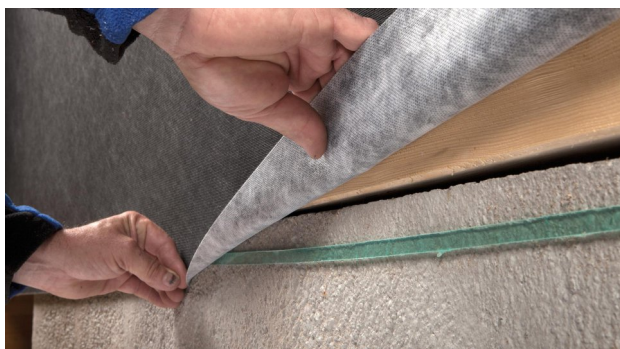

**7. Alternatively: Sticking to rough or mineral surfaces (e.g. floorboard)**

Stick line of adhesive to the subsurface, remove release film and stick the membrane in place, leaving slack to allow for expansion.

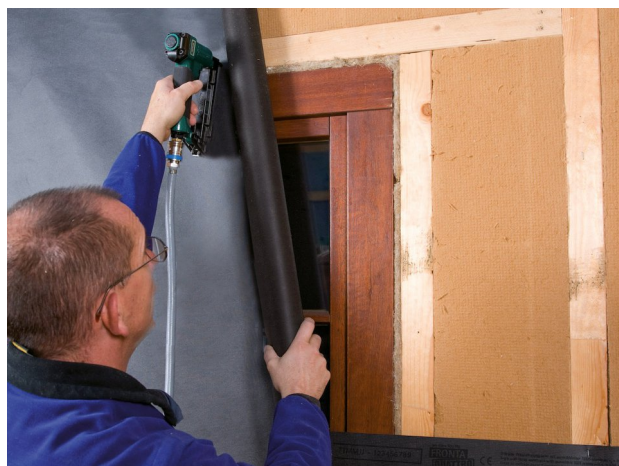

**8a. Sticking to windows**

Install membranes continuously over window openings and attach them all around the window using a stapler. Then cut open the opening using a utility knife.



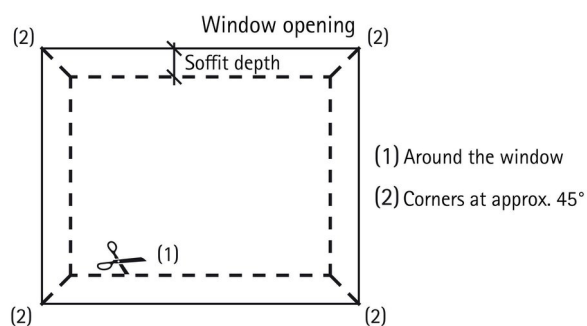

**8b. Sticking to windows**

In the case of recessed windows, cut into the membrane as shown in the sketch and guide into the soffit as far as the frame.

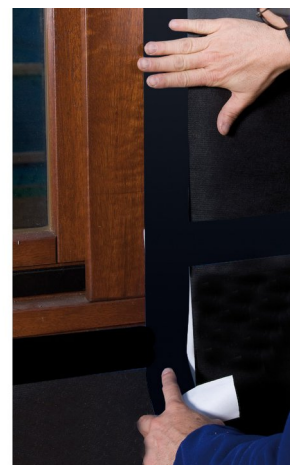
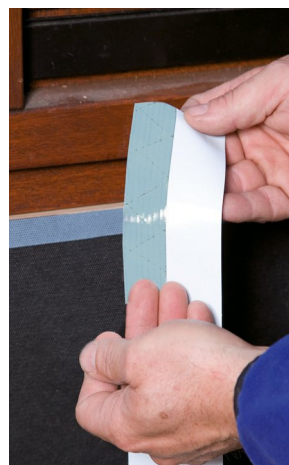

**9. Sticking to windows**

Stick the membrane to the window frame so that it is windtight using TESCON PROTECT.

Thanks to the split release paper it is possible to stick the tape first to the membrane and then, subsequently, to the window. Alternatively use TESCON VANA or TESCON INVIS.



**10. Sticking to cables and pipes**

Place KAFLEX or ROFLEX sealing grommets over the cable or pipe and stick to the membrane.

In the case of large gap widths, stick over the blue cable grommet using TESCON INVIS.

Tape the pipe grommets to the membrane with TESCON INVIS.

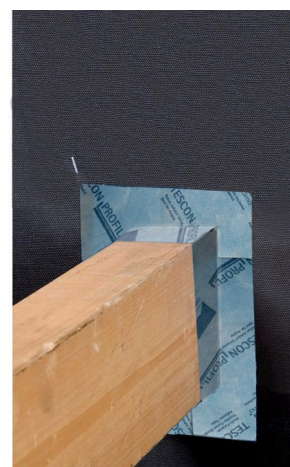

**11. Corner sealing**

Corner adhesive tape TESCON PROTECT with split release paper for angles. Prefold the tape into an L-shape, remove the first release paper and stick down the first side.

Then remove the remaining film and stick down the second side.

Alternatively use the black TESCON INVIS.

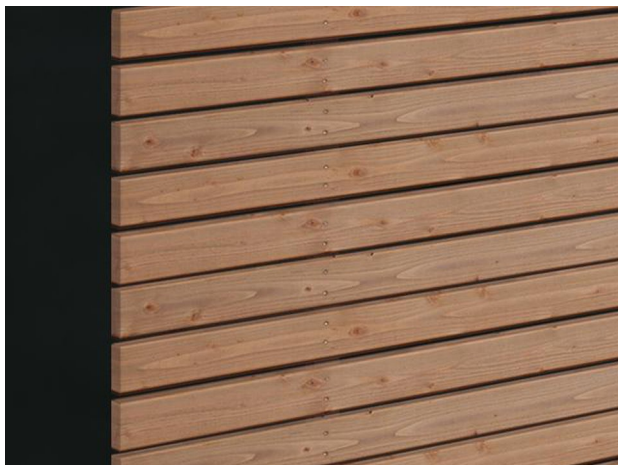

## 12. Installation of decking

Horizontal or vertical installation of decking

SOLITEX FRONTA WA: Only for closed decking.

SOLITEX FRONTA QUATTRO: For gaps up to max. 35 mm (1 3/8").

SOLITEX FRONTA QUATTRO FB: For gaps up to max. 30 mm (1 1/4").

SOLITEX FRONTA PENTA: For gaps up to max. 50 mm (2").

## General conditions

SOLITEX FRONTA QUATTRO membranes must be laid with the printed side facing outwards. The membranes are to be installed horizontally in a taut manner with no sagging.

When using behind open jointed façades the gaps must not be more than 35 mm (1 3/8"). The width of the boarding: min. 3 x gap width. The distance between the façade and the membrane must be at least 20 mm (1").

The membrane must not be secured in areas where water collectively drains off.

Additional measures during the building phase (e.g. covering with tarpaulin) should be taken in the case of occupied buildings or buildings that need particular protection. Covering with tarpaulin should also be considered in the case of extended interruptions to work.

---

The information provided here is based on practical experience and the current state of knowledge. We reserve the right to make changes to the recommended designs and processing or to make alterations due to technical developments and associated improvements in the quality of our products. We would be happy to inform you of the current technical state of the art at the time you use our products.

Further information about the application and construction can be found in the pro clima planning documentation. For queries please call the pro clima technical hotline on +49 (0)6202 278245.

---

### MOLL

**bauökologische Produkte GmbH**

Rheintalstraße 35 - 43

D-68723 Schwetzingen

Fon: +49 (0) 62 02 - 27 82.0

eMail: [info@proclima.de](mailto:info@proclima.de)